



Waun Fawr

Cwmrhydyceirw, Swansea, SA6 6FQ

£1,250 Per Calendar Month



Available on 18/08/2026

Coming to the market is this stunning three bedroom 'Ashford', end terrace house that is in close proximity to the DVLA, Morriston Hospital and the M4 for commuting in and out of the Swansea area.

Newly built in 2023, this gorgeous property provides 3 good sized bedrooms, a fully fitted kitchen complete with white goods, a lounge, a family bathroom and a low maintenance garden.

In addition, these properties have parking for 2 cars with one of the spaces having access to an electric vehicle charging point.

Images are for marketing purposes only



Area Map

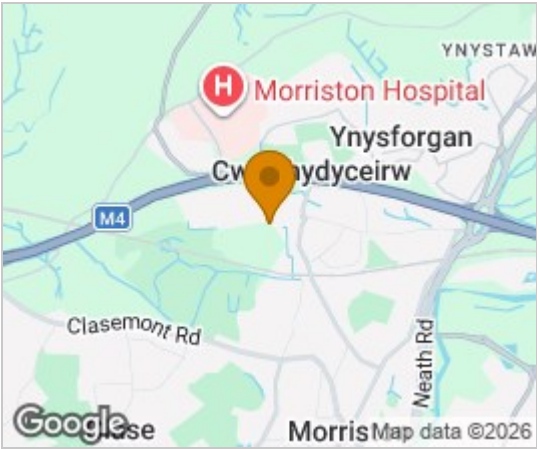

Floor Plans

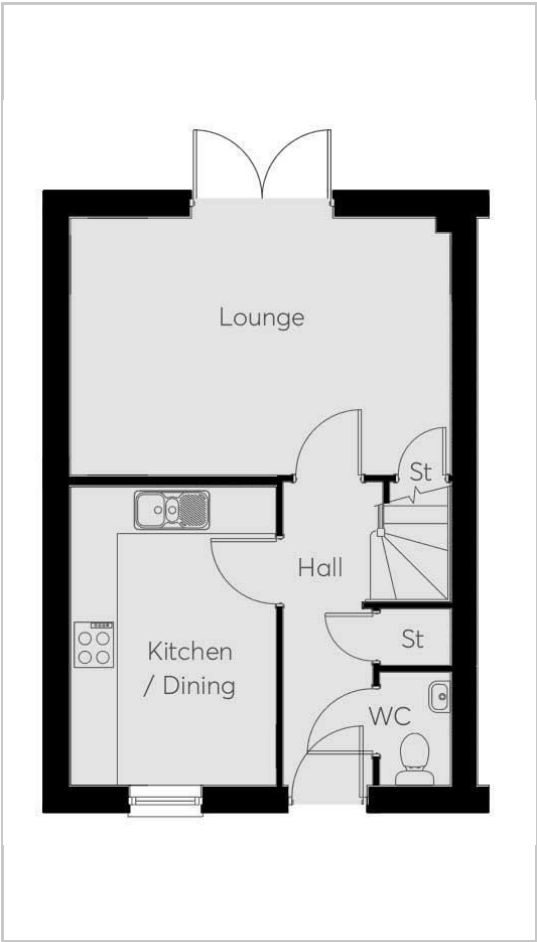

Energy Efficiency Graph

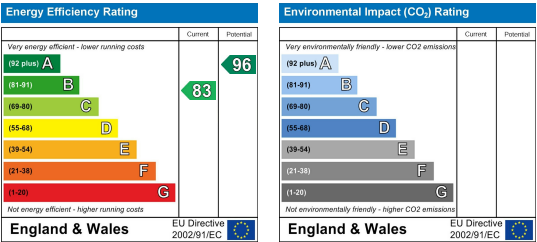

These particulars, whilst believed to be accurate are set out as a general outline only for guidance and do not constitute any part of an offer or contract. Intending purchasers should not rely on them as statements of representation of fact, but must satisfy themselves by inspection or otherwise as to their accuracy. No person in this firm's employment has the authority to make or give any representation or warranty in respect of the property.